

Studio T2

Features

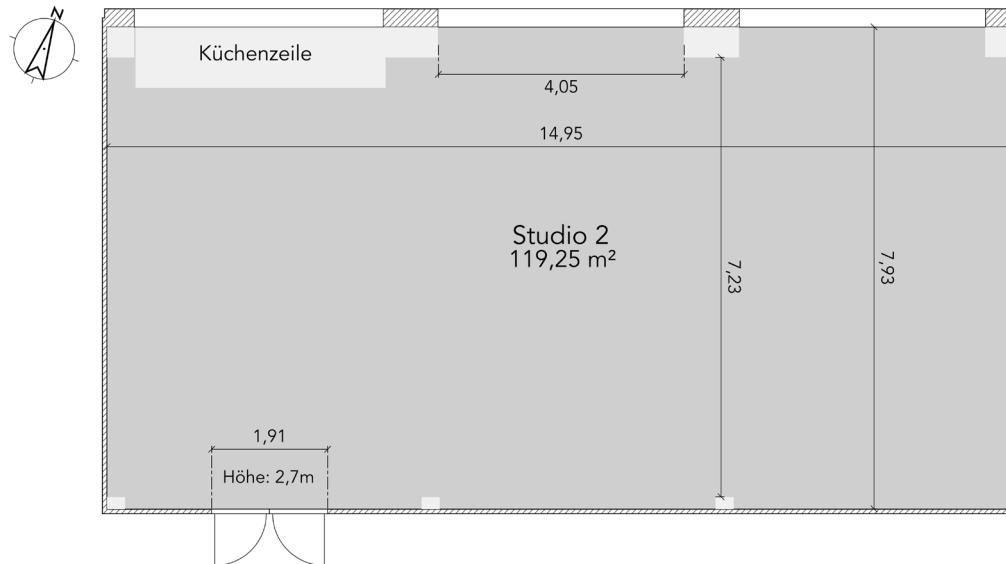

STUDIO AREA	Daylight studio on 120m2 // Can be combined with Studio T1 4x4m windows // Can be completely darkened at the touch of a button Ground level access // Parking directly at the studio
CEILING HEIGHT	5,7m
POWER SUPPLY	2x Powerpacks with 2x 32A red and 6x Schuko each Various extra secured Schuko sockets
STUDIO EQUIPMENT	Mobile work table with power supply Bluetooth sound system incl. Ipad // Spotify
EQUIPMENT	Inhouse Rent // Profoto, Arri, Brieze, Tripods, Grip and Consumables
MAKE UP & STYLING	1 mobile, illuminated make-up station 2 rolling clothes rails with 20 hangers each 1 steamer and iron/board each available
DINING AREA	Dining table and seating for about 8 people
KITCHEN	Espresso machine with milk frother Fridge filled with beverages

Studio T2

STUDIO

SPREE GRAPHEN STUDIOS



Studio T2

STUDIO

SPREE
GRAPHEN
STUDIOS



Studio T2

STUDIO

SPREE
GRAPHEN
STUDIOS

