

Studio 2

Features

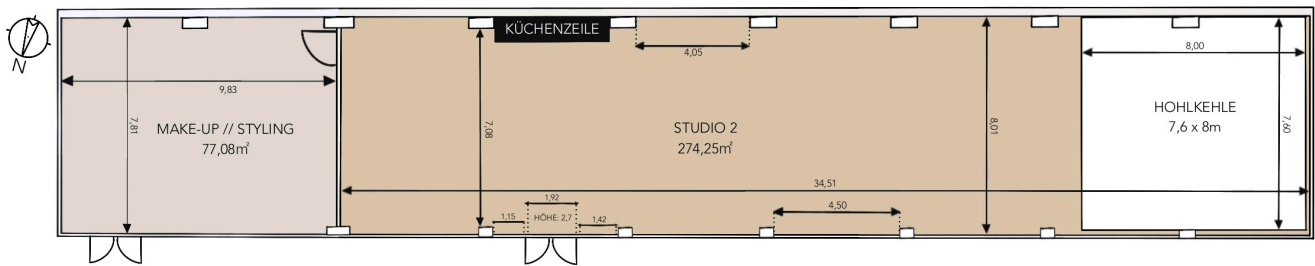

STUDIO AREA	Daylight studio on 275m ² plus 77m ² styling. Can be combined with Studio 1 and/or 3 4x4m windows // Can be completely darkened at the touch of a button Climate ceiling // Surface heating and cooling system Ground level access // Parking spaces directly in front
CEILING HIGHT	5,7m // Equipped with trusses over the complete studio area
CYCLORAMA	Width: 7,6m // Depth: 8m // Height: 5m // 61m ² floor space
POWER SUPPLY	2x Powerpacks with 2x 32A red and 6x Schuko each 1x 63A red
STUDIO EQUIPMENT	Mobile work table with power supply Back wash basin in styling area Well-stocked beverage refrigerator Powerful high-end sound system incl. Bluetooth Ipad with Spotify access
EQUIPMENT	Inhouse Rent // Profoto, Arri, Brieze, Stative, Grip und Verbrauchswaren
MAKE UP & STYLING	77m ² styling 3 make-up stations // 2 rolling clothes rails with 20 hangers each 1 steamer and iron/board each
DINING AREA	Dining table and seating for about 12 people
KITCHEN	Fully equipped kitchen // Coffee/Esspresso machine

Studio 2

STUDIO

SPREE GRAPHEN STUDIOS

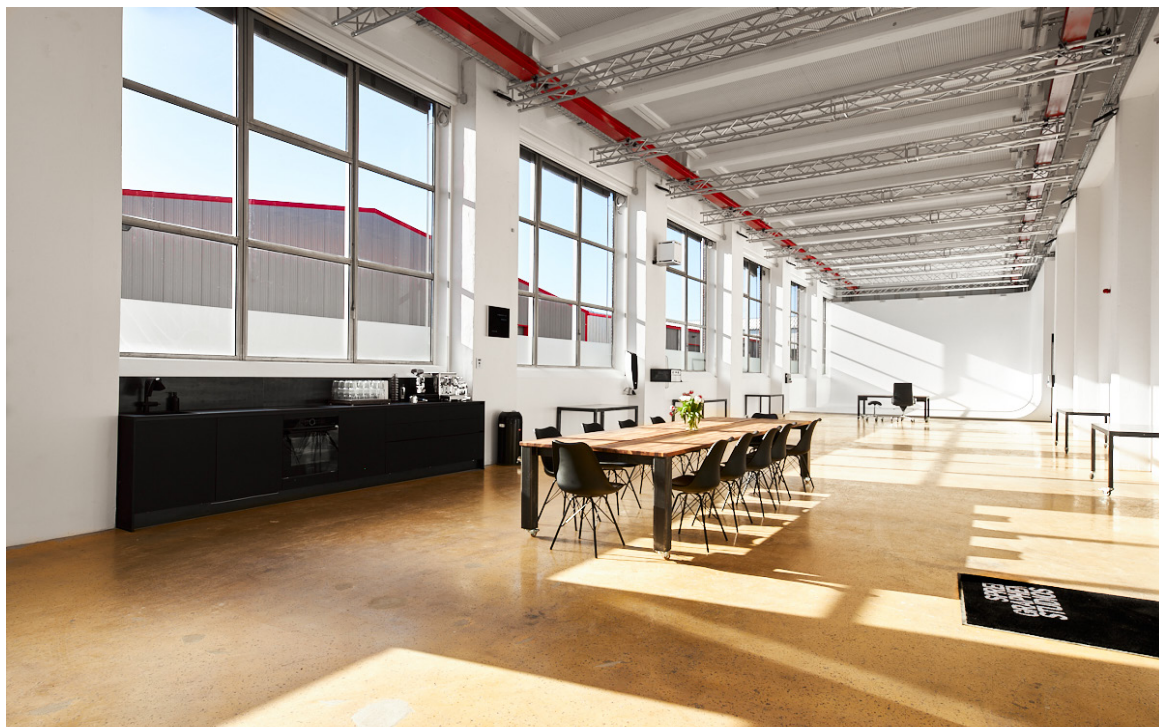

Studio 2

STUDIO

SPREE GRAPHEN STUDIOS

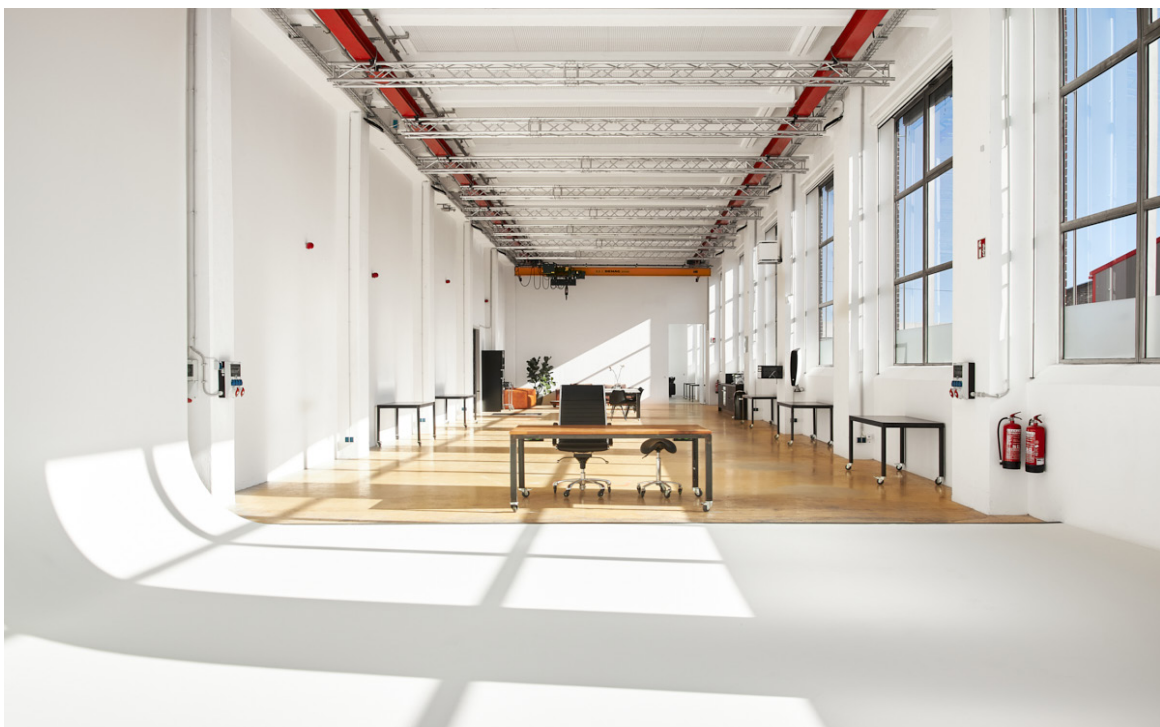

Studio 2

STUDIO

SPREE
GRAPHEN
STUDIOS



Studio 2

SPREE
GRAPHEN
STUDIOS



Studio 2

SPREE
GRAPHEN
STUDIOS



Studio 2

Traversen

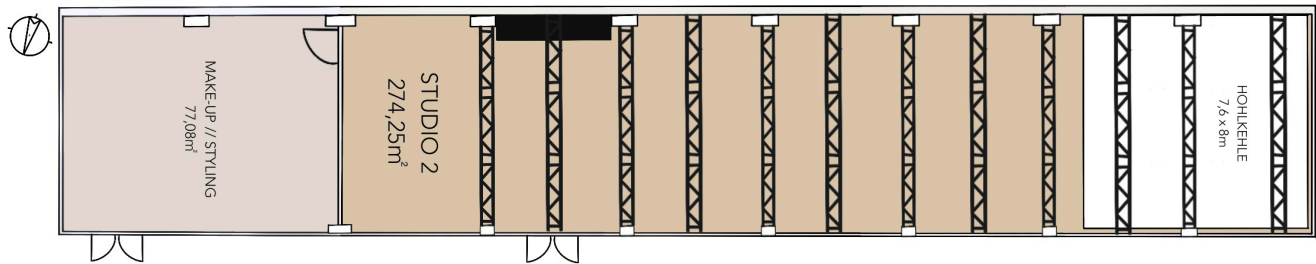

TECHNICAL DATA

- 12 Trusses over the complete studio area
- Hanging at a height of 5,2m
- Length of 7m or 6m between the columns
- Central maximum point load of 500kg
- Uniformly distributed load of 150kg
- Electronic riser of easy rigging is available and can be rented